

Page 269

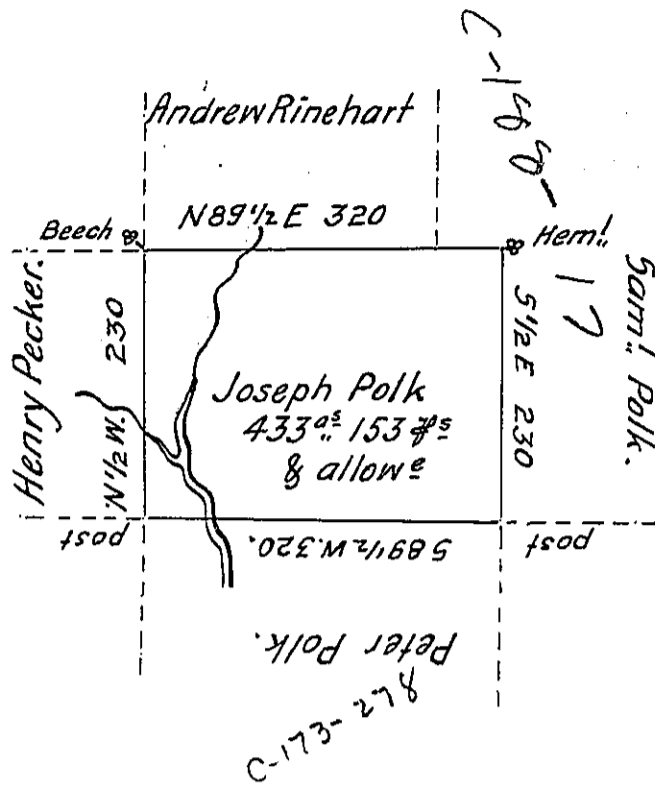

A Draught of a tract of land called \_\_\_\_\_ Situate in the County of Luzerne, Adjoining Andrew Rinehart & others, surveyed the 17<sup>th</sup> day of Novem<sup>r</sup> 1792. for Joseph Polk in pursuance of a Warr<sup>t</sup>. bearing date the 3<sup>d</sup> day of April 1792. Containing Four hundred thirty three Acres & one hundred & fifty three perches, & the usual allowance of Six <sup>7</sup>/<sub>100</sub> Cent for roads &c

To Dan<sup>l</sup>. Brodhead Esq<sup>l</sup>. } Anty. Grothers D.S.  
 Surveyor General. }

IN TESTIMONY that the above is a copy of the original remaining on file in the Department of Internal Affairs of Pennsylvania, made conformably to an Act of Assembly approved the 16th day of February, 1833, I have hereunto set my Hand and caused the Seal of said Department to be affixed at Harrisburg, this fifteenth day of June 1906

*Isaac B. Brown*  
 Secretary of Internal Affairs.